

DETAIL A
SCALE 3:1

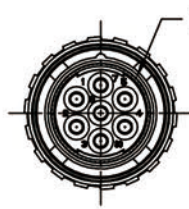

DETAIL A

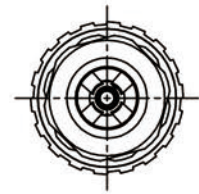
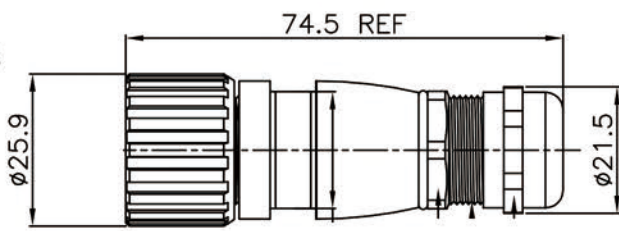

Detailed Product Description:
 Waterproof Connector Rating Is IP67
 They Can Not Be Used Permanently Under Water.
 Connector Electrical Character
 Rating Voltage: 250V AC/DC ,
 Rating Current : 20A
 Insulation Resistance: >100M ohms
 Contact Resistance Of Connector ≤5m ohms
 Mechanical Characteristics:
 Mating / Cycle >100 Cycles
 Operating Temperature: -40°C ~ +115°C
 Design From DIN EN60664 AND DIN EN61984
 Applicable Wire: 2.5mm²(14AWG),
 *All Materials Are RoHS Compliant.

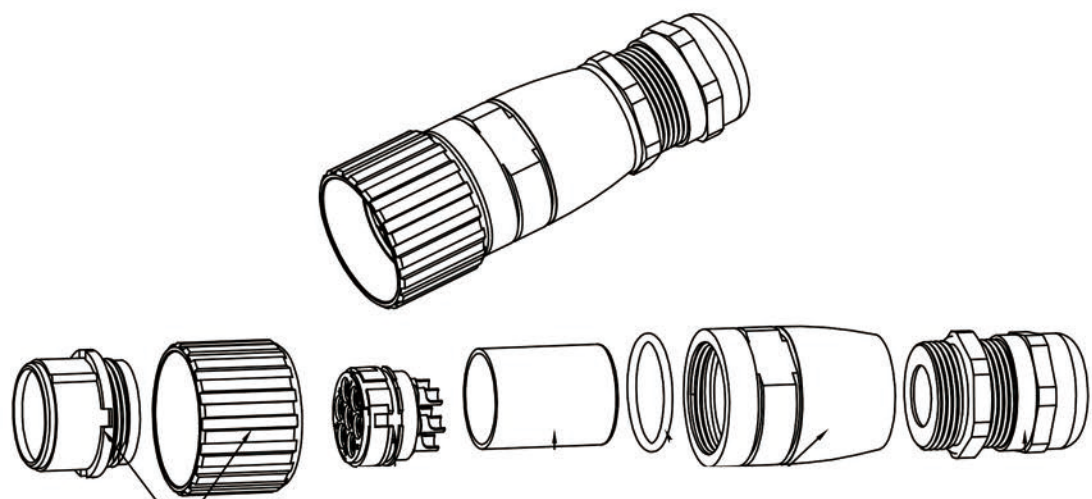

SIGNAL® Shenzhen Signal Electronics co.,Ltd		TITLE M23 7 PIN FEMALE HEAD METAL ASSEMBLY (M23*1.0)	
DRAWING BY	DATE	SGN NO 230007-02-001	REV.
CHECKED BY	DATE	DWG NO	S0
CHECKED BY	DATE	CUSTOMER	
APPROVED BY	DATE	TOLERANCES ARE: DECIMALES ANGLES .x ±0.5 x° ±2.0° .xx ±0.20 .x' ±1.0°	
THE INFORMATION CONTAINED IN THIS DRAWING IS THE SOLE PROPERTY OF SIGNAL COMPANY. ANY REPRODUCTION IN PART OR WHOLE WITHOUT THE WRITTEN PERMISSION OF SIGNAL COMPANY IS PROHIBITED.		THIRD ANGLE PROJECTION 	SIZE: A4 UNITS: mm SCALE: 1:1 SHEET: 1 OF 1